

LRIWS - Recessed Shelf

- Ligature resistant
- Vandal resistant
- Hygienic and easily cleaned
- Proven long-term product life
- Anti-microbial solid surface

DESIGN

The Intersan behavioral healthcare shelf is made from highly damage resistant composite solid surface polyester resin. Manufactured as part of Intersan's behavioral healthcare suite of products, the LRIWS-shelf is tested to the highest standards and specifications.

The LRIWS is intended for recessed installation. Mounting hardware (except wall anchors) is provided.

TECHNICAL

Dimensions: 20" x 8" x 5"

Material: Anti-microbial Solidguard

Screws: #6 - Tamper Resistant



MODEL

Dimensions: 20" x 8" x 5"

Material: Anti-microbial Solidguard

Screws: #6 - Tamper Resistant

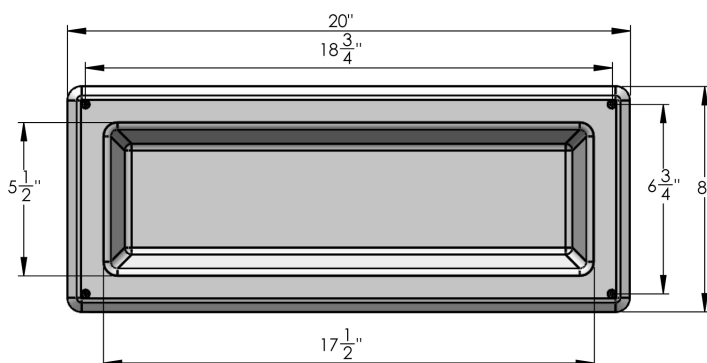

MODEL SELECTION

Base Model (must specify)

LRIWS Ligature Resistant Recessed Shelf

Color (must choose one):

-PW Polar White

-DB Designer Black

-CG Concrete Grey

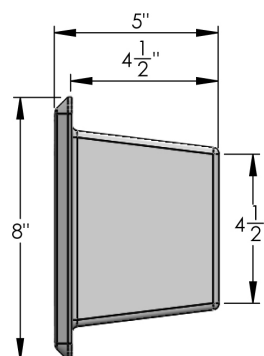

WARNING: Cancer and Reproductive Harm
www.P65Warnings.ca.gov